

Sommerhuber Dry Room Seat

Ergonomically shaped ceramic seat for dry areas made of large-area heat storing ceramics. Each seat consists of a ceramic backrest, seat and plinth. Velvety soft ceramic surface with optimal hygiene aspects. Thanks to specific characteristics heat storing ceramics emit mild areal infrared warmth, which enhances blood circulation and results in superior relaxation and maintaining of vitality.

Descriptive size: W/L/H ~ 87 / 45;61;72 / 133 cm
 Article no.: 651 910; 651 911; 651 912

Delivery in separate components.
 Installation in accordance to assembly recommendation.

Available in 15 different glazes.

- Consisting of backrest, seat and plinth element.
- Standard width of joints ~ 3 mm
- EPS sub-construction
- Available 22,5° and 45° corner seats
- Surface temperature ceramics:
 uncovered up to max. 50°C.
 Recommended temperature: ~ 34°C +/- 2°C
- Individual cutting to length in accordance to exact measurements
- Optional: LED illumination

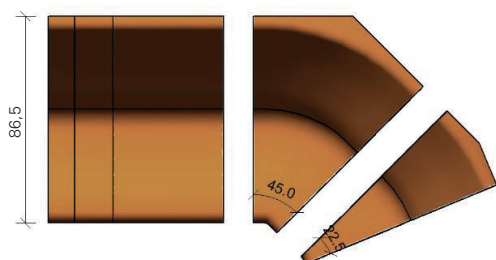
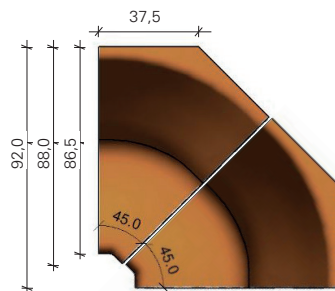
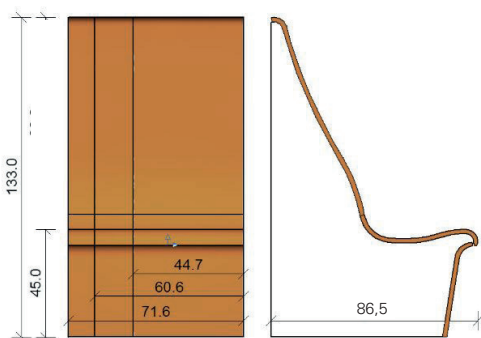

All measurements are nominal sizes.
 All measurements in cm.

This product is maintenance free.

For proper cleaning please use only cleaning agents with PH value between 5.0 - 9.0. Please use soft cleaning clothes only. Abrasive brushes or high-pressure cleaners could damage the glazed surface.